

8081569

PERMISSIBLE VARIATION ON COMMON
FRACTION DIMENSIONS TO MACHINED SURFACES
TO BE ± 0.010 UNLESS OTHERWISE SPECIFIED.
FABRICATION TOLERANCE.

REMOVE ALL SHARP CORNERS
UNLESS OTHERWISE SPECIFIED.

COUNTERSINK ALL TAPPED
HOLES 118° 1/8" 1 OAK THRU 5/16".

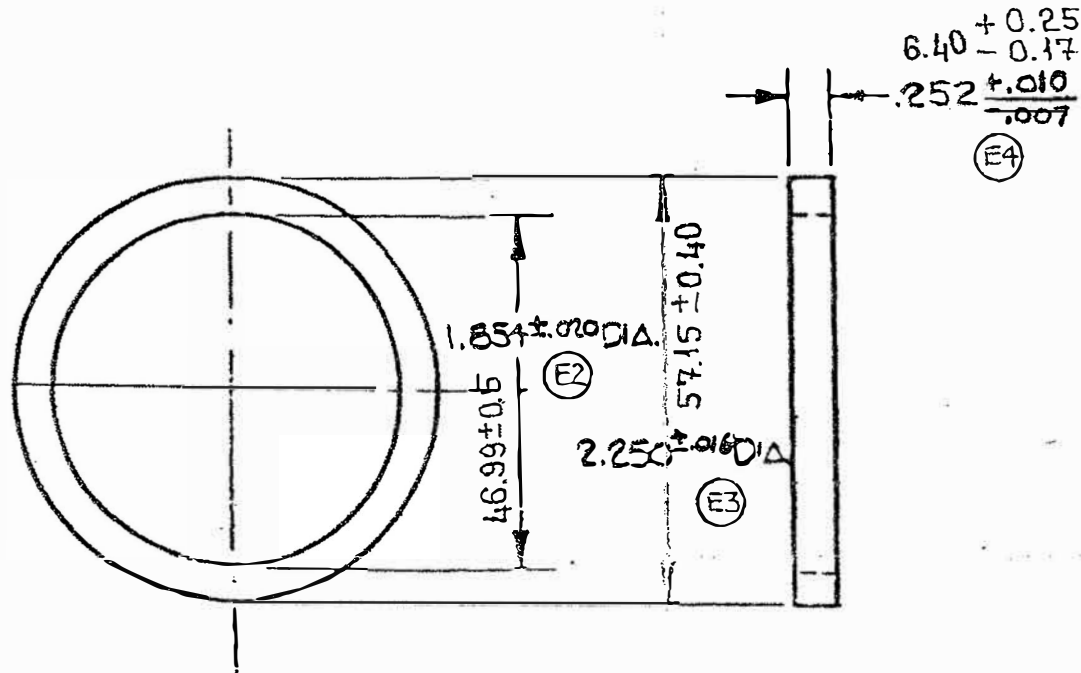

Yer No	Sira No
1	236

STANDARD PART

APERTURE CARD
ONLY

ENGINEERING APPROVAL
OF SOURCE REQUIRED

T\$ 260.003

		EK11								MATERIAL RUBBER		NAME OF PART		PART NO.		IT. NO.	
												ELECTRO-MOTIVE DIVISION					
												GENERAL MOTORS CORPORATION					
												LA GRANGE, ILLINOIS, U.S.A.					
												GASKET-1 1/4 FLANGE					
												DATE OF PRINT					
												PART NO.					
												8081569					